

Existing Parking and Landscape Plan - 1:1250

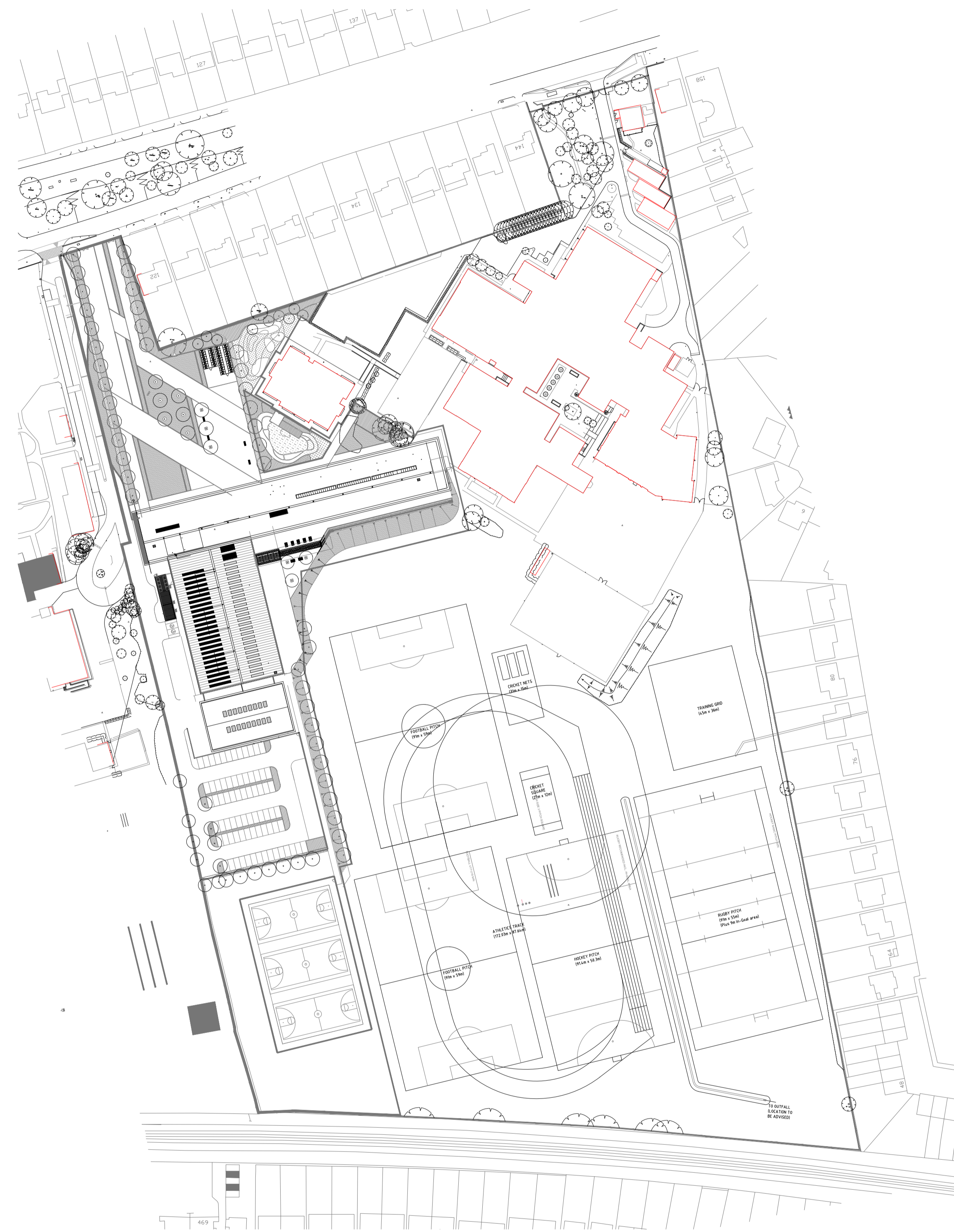

Proposed Parking and Landscape Plan - 1:1250



STATUS: AWAITING APPROVAL

PROJECT STAGE: S1 - Preliminary	DRAWN BY: WRS	CHKD BY: <input type="checkbox"/>
CLIENT: Southchurch School	PROJECT NO: 453-P03	PAGE NO: 453-P03
PROJECT: Southchurch School Sports Hall	DRAWING: Landscape and Parking	REVISION: <input type="checkbox"/>

SCALE:
1:1250 on A1

BUILDER INFORMATION:
DO NOT BUILD FROM ANY DRAWINGS PACKAGES THAT DO NOT SAY, BUILDING CONTROL APPROVED OR IN CONSTRUCTION PACKAGES. IT IS THE RESPONSIBILITY OF THE BUILDER TO CONTACT THE ARCHITECT TO REQUEST/CONFIRM THE RIGHT DRAWING PACKAGE IS ON SITE. PLEASE BE ADVISED THAT ALL DRAWING PACKAGES WILL ALSO HAVE STRUCTURAL ENGINEERING WORKS ATTACHED. DO NOT BUILD WITHOUT ALL PAPERWORK.

DRAWING NOTES:
ALL ITEMS, NOTES, DIMENSIONS AND GENERAL DESIGN CONTAINED IN THIS DRAWING ARE FOR GUIDANCE PURPOSES ONLY. NOMINATED BUILDER AND PERSON RESPONSIBLE FOR THE PROJECT SHOULD MAKE A THOROUGH CHECK PRIOR TO COMMENCEMENT OF WORKS AGAINST SITE, DRAINAGE SERVICE DRAWINGS, CURRENT BUILDING REGULATIONS, BRITISH STANDARDS AND CODES OF PRACTICE. FAILURE TO DO SO WILL BE AT THE LIABILITY OF THE BUILDER/CONTRACTOR NOT THE ARCHITECT.

THE CONTRACTOR IS TO ALLOW WITHIN THEIR PRICE FOR ALL ITEMS NOT LISTED BUT THAT WILL BE REQUIRED TO COMPLETE THE WORK IN ACCORDANCE WITH ALL CURRENT LEGISLATION.